

Basic Detail Report

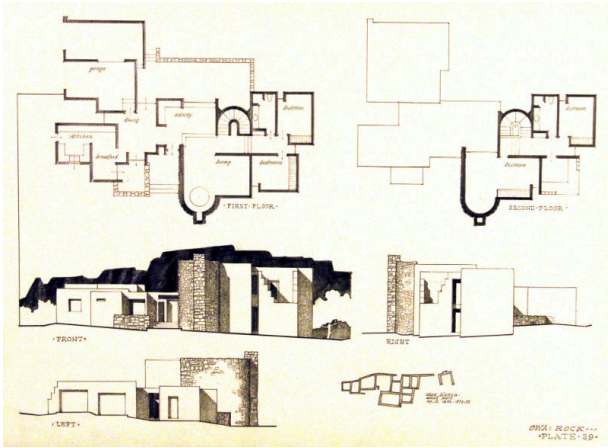

Owa: Rock, Plate 29

Date

1965-1967

Primary Maker

William Lumpkins

Medium

Graphite on paper

Description

A) Architectural drawing of a first and second floor plans and the front right and left of a house. At bottom right is a small drawing of a Pueblo floor plan inscribed "Casa Blanca, west part, fig 15, 16th, 1894-95" b) Two drawings of sections of house, top is kitchen, dining, activity, a hall; bottom is section of living room, second floor, bedroom, activity and terrace.

Dimensions

Support (ab): 18 x 24 1/8 in. (45.7 x 61.3 cm)