

# Basic Detail Report

---

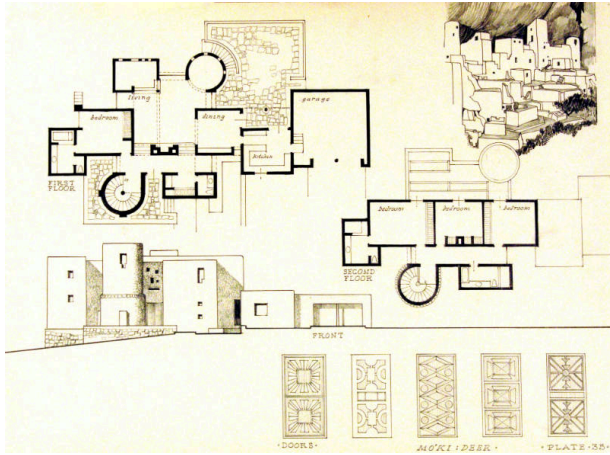

## Mo'ki: Deer, Plate 33

### Date

1965-1967

### Primary Maker

William Lumpkins

### Medium

Graphite on paper

### Description

Architectural drawing of a floor plan of the first and second floors with a large circular stairway being prominent in the plan. The front elevation of the house is below. At bottom are five decorative door panels. The upper right corner has a drawing of a Pueblo like Mesa Verde

### Dimensions

Support: 18 x 24 1/8 in. (45.7 x 61.3 cm)